



Welcome to Nailsea School



Welcome to Nailsea School 2024

Welcome to our school, we hope this booklet will help you answer any queries you may have, and will provide a helpful overview. For further details, please visit our website: www.nailseaschool.com

CONTENTS

Hello & Welcome

Open Evening —Room Guide

Open Evening Map

General FAQs

- Transition
- Transition day & Evening
- Uniform
- Enrichment
- Special Educational Needs
- Teaching Groups
- School Day
- Behaviour
- Travel
- Pupil Premium Funding
- Assessment and Reporting
- Results

Subject FAQs

- Art & Design
- Drama
- English
- Enterprise
- Film Studies
- Geography
- History
- Maths
- Media
- Modern Foreign Languages
- Music
- Physical Education
- Religious Studies
- Science



Welcome to Nailsea School 2024

Hello & welcome to Nailsea School,

I am delighted that you wish to find out about our school – a place that I consider to be a fantastic community to work and to learn. By ensuring your child's happiness remains our first priority, we know they will go onto achieve their full potential here with us.

Nailsea is a completely comprehensive school offering high quality educational opportunities to students of all abilities and aptitudes.

We care deeply not only about the academic development of our students but also their emotional and personal development. We recognise that every student has their own individual strengths, gifts and talents and our aim is to ensure that these are all developed to their full potential.

We want to help young people to be fit for the demands of a complex, global society. We have a track record of students being involved in outdoor education, musical, dramatic and sporting enrichment, and in serving both the school and our wider community.

Nailsea is a happy school where students and teachers enjoy working together. We have a strong ethos based on core values of respect, tolerance and courtesy. We set high standards of behaviour. Our young people gain the confidence to take their place in society and develop the skills and attitudes to enable them to succeed in their chosen paths.

I am privileged to be able to work with a dedicated and gifted staff body who work in partnership with parents, governors and the local community to ensure that our young people are supported, challenged and inspired to achieve.

Thank you for your interest in our school and I look forward to welcoming you.



A handwritten signature in blue ink that reads "D Elliott".

Mrs D Elliott
Headteacher

Welcome to Nailsea School 2024

Open Evening - Room Guide

SUBJECT	ROOM	HEAD OF DEPARTMENT
Art & Design	Room 149	Ms Davies
Drama	Room 146	Mr Lloyd
English	Room 125 & Library	Ms Jacobs
Enterprise (Food)	Room 9	Mr Kirwan
Enterprise (Design Tech)	Room 61 & 62	Mr Kirwan
Enterprise (CAD / 3D Printing)	Room 63	Mr Kirwan
Enterprise (ICT)	Room 155	Mrs Wheeler
Enterprise (Textiles)	Room 156	Mr Kirwan
Film Studies	-	Miss Britton
Geography	Room 117	Mrs Thompson
History	Room 117	Mrs Ginnis
Maths	Room 42 & 43	Mrs Coates
Media	-	Miss Britton
Modern Foreign Languages	Room 129	Miss Cahill
Music	Room 53	Mr Pate
Physical Education	Sports Hall	Miss Wild
Religious Education	Room 117	Mr Jones
Science	Super Labs A & B	Ms Evry



Welcome to Nailsea School 2024

Open Evening Map

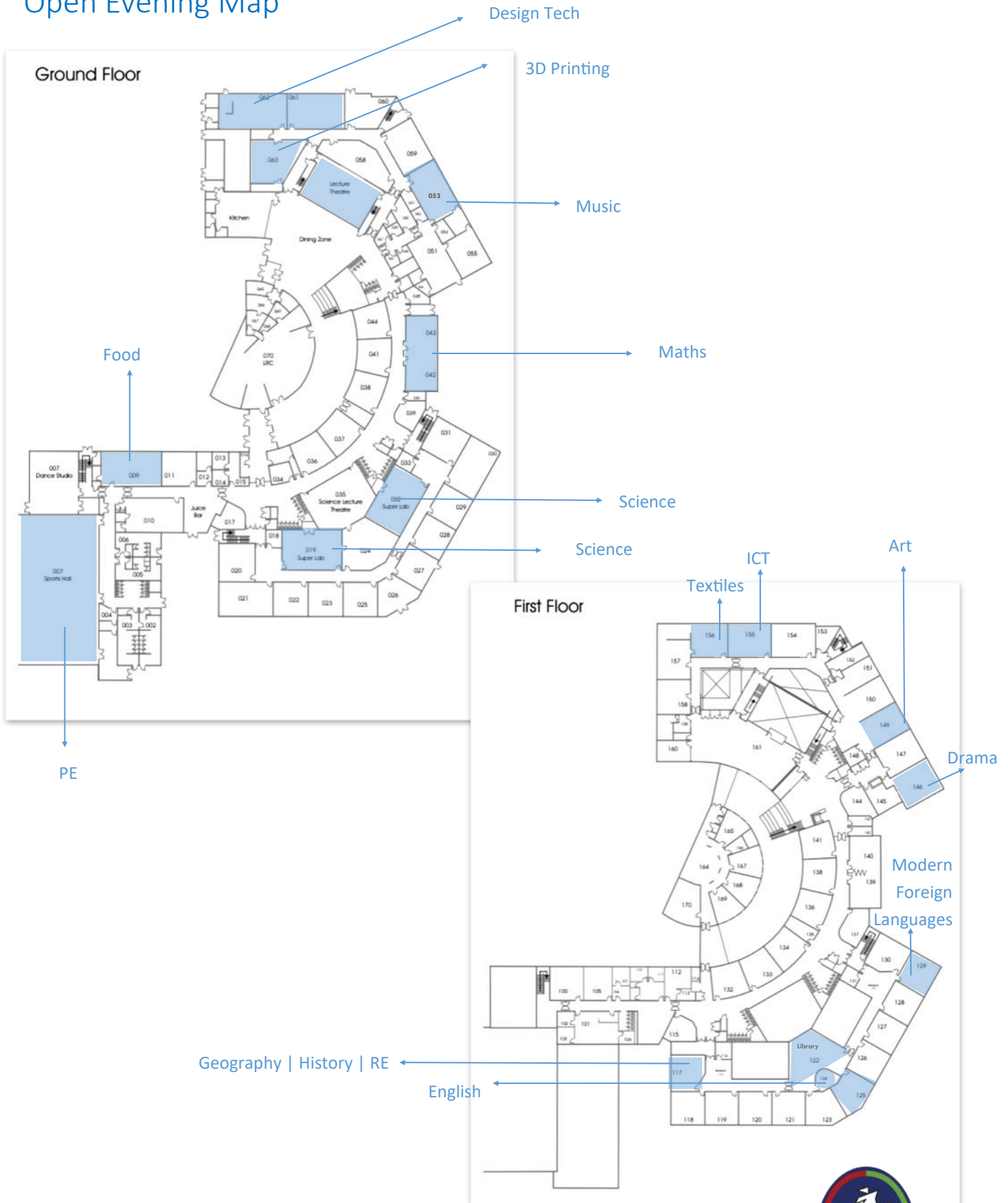

Welcome to Nailsea School

Transition

For those families that are successful in securing a place at Nailsea School, transition information will be sent out shortly after North Somerset confirms places in March 2025. This will contain important dates and information about the transition process as well as a link to online forms which will need completing before your child joins in September 2025.



Transition Day and Evening

Year 6 students across Nailsea will be invited to spend the day at their chosen secondary school during the summer term before they join. In 2025 this is proposed to take place on Thursday 10th July. Students at Nailsea School are asked to arrive for an 8.30am start. During

the evening parents are invited to meet staff and attend a presentation to find out key information about the school. Further information about these events will be sent out to families in the spring.

Uniform

A full uniform list is on the school website.

The branded school jumper, tie and optional fleece are available from School Togs. PE kit can also be ordered from this supplier. Please visit their stand during Open Evening for more information.

JUMPER	School jumper with the school badge
SHIRT	White shirt with buttons at the neck (long or short sleeve)
FLEECE	Branded school fleece with school badge worn over jumper (optional)
TIE	Clip on House Tie
TROUSERS	Tailored black trousers. Skin tight fitting style trousers are not allowed. Jeans and leggings are not allowed. Ankles should not be visible.
SHOES	Black leather-look shoes or trainers (no canvas, boots or colour flashes)

Enrichment

The latest copy of the extra-curricular booklet with information about enrichment opportunities in school is available on the school website featuring over 40 clubs from 'Craft to Computing' on offer throughout the year.

Welcome to Nailsea School

Special Education Needs



Students with SEN are those who experience significantly greater difficulty in learning than the majority of their peers or who have a disability which prevents or hinders them from making use of the educational facilities that are provided.

The Learning Support Team co-ordinates the whole school response to individual learning needs across ranges of age, ability and curriculum. Discussions with primary schools take place in the term prior to students arriving to identify any barriers and put strategies in place ready for Year 7 in September.

The Hub is an additional internal provision within school where the SEND team is located and whole school intervention is delivered in addition to the resource base.

The North Somerset resource base is a provision whereby some of the student timetable is delivered within the Hub location and the rest is accessed in the mainstream. This provision is specifically for ASD students and there is an entry criteria, which is managed by North Somerset SEND team.

Our SENCo is Melody Cole. She can be contacted at the school on 01275 852251, mcole@nailseaschool.com.

Teaching Groups

Students are taught in mixed ability teaching groups. These groups change for PE, Technology and Ethics and students are in sets for Maths.

The Transition Team gather attainment information for all students from their primary schools and use their KS2 scores to help when placing students into groups. Baseline tests are also carried out in Term 1 of Year 7 to facilitate adjustments in groups if necessary.

Mon, Wed, Thurs, Fri		Tues	
8:30 – 9:00	Tutor time	8:30 - 9:10	Extended Tutor
9:00 – 10:00	Period 1	9:10 - 10:05	Period 2
10:00 – 11:00	Period 2	10:05 - 11:00	Break
11:00 – 11:20	Break	11:00 - 11:20	Period 3
11:20 – 12:20	Period 3	11:20 – 12:20	Period 3
12:20 – 13:20	Period 4	12:20 – 13:20	Period 4
13:20 – 14:00	Lunch	13:20 – 14:00	Lunch
14:00 – 15:00	Period 5	14:00 – 15:00	Period 5

School Day

Students follow a two week timetable with the school day structured as illustrated.



Welcome to Nailsea School

Behaviour

Students are rewarded and praised for positive actions, with opportunities to gain Reward Points in recognition of excellent work, attitude and contribution to school life. Behaviour that does not follow the school expectations will be sanctioned using the Behaviour Points and the Consequence System (C1-7) which includes detentions, internal exclusion and suspensions. Full details of our Rewards and Sanctions can be found in our Behaviour Policy on the school website.



Travel

We encourage as many of our students as possible to walk for part or the whole of their journey to school. Students that cycle can leave their bikes in the racks provided on site which are locked for the duration of the school day.

School bus services cover the Long Ashton and Clevedon/Congresbury/Yatton/Cleeve areas.

Services have limited spaces so please register your interest with the school Finance Office and places are then offered on a first come first served basis. Pick up times and routes are confirmed according to demand. Payment is for the whole term (we cannot accommodate part week or part term reservations) and is requested a term in advance once a place is confirmed.

Pupil Premium Funding

Registering for Free School Meals also enables the school to access Pupil Premium funding which we use to help your child participate fully in all learning activities. This funding can also help pay for extra curricular activities and eligible pupils may also be invited to attend special events, workshops and activities which we feel would be beneficial to them.

If you have any questions about Free School Meals and Pupil Premium, or would like some help with your application, please contact Sophie Ruddy at the school 01275 852251, srutty@nailseaschool.com.



Welcome to Nailsea School

Assessment and Reporting

Initial assessments in the first weeks of Year 7, Term 1, are used alongside KS2 scores and teacher assessments from primary schools to inform targets and setting from Y7 onwards.

Subjects assess progress periodically and the results are fed back to parents in reports and are used to inform discussions at parents' evenings.

Academic reports are issued twice a year providing information on the progress students are making in each of their subjects. Reports show scores indicating students' attitudes to learning, house and behaviour points.



Results

We are exceptionally proud of our students' unstinting efforts and determination. We know that the combination of a carefully tailored curriculum for each student, providing quality and depth of learning, alongside our outstanding pastoral care and child-centred approach, leads to exceptional outcomes for every student.

LEVEL 2 (GCSE & BTEC)	2024	2023
4+ in English	79%	86%
4+ in Maths	73%	78%
4+ in English & Maths	67%	77%
5+ in English & Maths	50%	51%
All entries 9–7	21%	25%
All entries 9–4	75%	72%

Our results compare favourably with other schools, both nearby and above the national average. The gaps between different groups of learners are not only better than the national average but also continue to narrow at a significant rate, particularly boys and disadvantaged students. Alongside this, the number of students attaining the highest grades (7+) has continued to be in line or exceed national outcomes at this level.

The progress made by students at Nailsea has accelerated rapidly in recent years, increasing on average by almost a full grade per student, making us a positive Progress 8 school. This means we are considerably above 'the national average' and that students make better progress than their Year 6 results projection.

Subjects at KS3

Year 6 Frequently Asked Questions



FAQs : Art & Design



We've put together a shortlist of frequently asked questions, we thought you might find useful. There is lots more information in the 'Student Life' section of our website, including what the curriculum covers for each subject in the 'curriculum maps' section. For further information please scan the QR code.

What do they learn in year 7 Art lessons?

Basic observational drawing and material handling skills such as painting. They also learn about art movements such as Cubism, and applying these skills and pieces of knowledge into a cohesive larger scale painting.

Do year 7s keep a sketchbook?

Yes, and they will work in this sketchbook in the majority of their lessons. These sketchbooks become a document of their artistic journey, and will be full of wonderful work by the end of KS3 .

What opportunities are there post KS3 if my child wants to develop their interest in Art?

We offer three Art & Design GCSEs in Fine Art, 3D Art and Photography. We feel these options offer a broad experience, and sufficient specialism for students to master knowledge and skills for future careers in the Creative industries.

Do you do any 3D work in art lessons?

Yes, there are opportunities to make clay models in KS3, and if students take the 3D Art GCSE option they can specialise in working three dimensionally.

What part does Photography play in your curriculum?

We encourage photographic responses in both home learning activities and in competitions at KS3. We offer GCSE and A Level Photography for any students wishing to expand of their experience, and to learn traditional and digital editing skills.



FAQs : Drama



We've put together a shortlist of frequently asked questions, we thought you might find useful. There is lots more information in the 'Student Life' section of our website, including what the curriculum covers for each subject in the 'curriculum maps' section. For further information please scan the QR code.

What extra-curricular drama is on offer?

We offer workshops after school and a club will run for part of the year, we work closely with the music department to develop our creative programme.

What is Drama for?

Learning soft skills, such as speaking confidently, understanding body language and empathy, working as a team and thinking creatively. Important skills regardless what pathway you chose.

Do you have to perform?

Yes, you do, but for the nervous it's a fun activity which helps build confidence and self esteem. There is also a small amount of book work which focusses on self-evaluation and we also mark the work during lessons.

What do you do in the lessons?

We have lots of fun and we study all of the skills needed for GCSE Drama.

How many times does Drama happen?

Two lessons a fortnight

Will my child do Drama in Year 7?

Students study Drama in Years 7, 8 and 9 and it is an option for GCSE and A Level.



FAQs : English



We've put together a shortlist of frequently asked questions, we thought you might find useful. There is lots more information in the 'Student Life' section of our website, including what the curriculum covers for each subject in the 'curriculum maps' section. For further information please scan the QR code.

What is studied in Y7?

We regularly review our curriculum to ensure we are studying a broad range of interesting and challenging texts. In Y7 we start with a poetry unit that is all about focusing on the language chosen by poets. We also study the novel 'Bone Talk', as well as the art of rhetoric, the magical places of Shakespearean comedy, and myths and legends. Our fortnightly reading lesson focuses on developing a love of reading as well as giving students the opportunity to discuss a shared text.

Is there additional support?

We aim to support all of our students through good quality classroom teaching. Those with specific additional needs will be supported through strategies within the classroom. At times, students may be selected to take part in a specific intervention with the SEN team and these are closely monitored and organised by our SENco.

What is English homework like?

Our Y7 students receive homework each week. This will focus on either vocabulary development for reading.

Do you have enrichment activities?

Competition Writing, Creative Writing Club, Creating Gaming Narratives will all be running this year.

What A levels are offered?

We currently offer A level Literature and A level Language.



FAQs : Enterprise



DESIGN & TECH



IT & BUSSINESS

We've put together a shortlist of frequently asked questions, we thought you might find useful. There is lots more information in the 'Student Life' section of our website, including what the curriculum covers for each subject in the 'curriculum maps' section. For further information please scan the QR code.

What is Enterprise at Nailsea?

The Enterprise department encompasses the subjects of Design Technology, Food Technology, Engineering ICT and Business. We've put together a shortlist of frequently asked questions, we thought you might find useful. There is lots more information in the 'Student Life' section of our website, including what the curriculum covers for each subject in the 'curriculum maps' section. For further information please scan the QR code.

How many lessons a fortnight do KS3 students have for Enterprise?

Five lessons over the two-week timetable in years 7, 8 and 9. There will be 3 weeks of induction to the subject learning the health and safety and basic skills required before starting four rotations of 9 weeks each.

What is studied in KS3?

Year 7*	Year 8*	Year 9*
Food Technology - Healthy Eating & nutrition	Food Technology - The science of cooking	Food Technology - Culture & Cuisines
Engineering / Design Technology - Wooden Toy design & manufacture	Engineering / Design Technology - Metal Animal Lamp design & manufacture	Engineering / Design Technology - Computer Aided Design (fusion 360) & 3D Printing
Textiles - Drawstring Bag design & manufacture	Textiles - Monster Cushion design & manufacture	Textiles - Upcycled T-Shirt creation
Information Technology - Scratch, Spreadsheets, Python	Information Technology - Animation, Microbit, SonicPi	Information Technology - Encryption, Spreadsheets, Python

*Business is embedded into all of rotations.

Why is studying the subjects within enterprise relevant to my child?

Studying Design Technology, Food Technology, Engineering, ICT, and Business is crucial for young people. Design Technology sparks creativity and problem-solving skills. Food Technology teaches nutrition and cooking expertise. Engineering fosters problem-solving and hands-on abilities. ICT is vital for navigating the digital world. Business knowledge equips them with economic and organisational understanding. These subjects provide a well-rounded education, preparing them for diverse careers and enabling them to shape the future.

Are the Enterprise subject's compulsory at KS4

Although all the enterprise subjects are optional at KS4 due to the diverse range of subjects on offer many of our students opt to study these subjects.



FAQs : Film Studies



We've put together a shortlist of frequently asked questions, we thought you might find useful. There is lots more information in the 'Student Life' section of our website, including what the curriculum covers for each subject in the 'curriculum maps' section. For further information please scan the QR code.

What is Film studies?

Film studies is the exploration of film as a piece of art and as a historical document. We analyse how films manipulate audiences through the use of 4 key areas: cinematography, editing, sound and mise-en-scene. We study a range of culturally diverse films, from global subtitled films to silent cinema to mainstream Hollywood. We also explore key concepts, such as auteur theory, ideologies and spectatorship.

In addition, we have an element which is more creative and practical. Students are able to produce their own short film/sequence or write screenplays for it.

Is it just watching films?

Whilst we do watch films in class, it is much more than this! We study specific scenes in films and apply the key concepts we have learnt. Students are expected to know at least 3 sequences in detail from each film as their exams will ask them to analyse them.

Why should students study film?

Film is an important medium to our society. We explore how films reflect their production context and how films have changed according to society's expectations. Students learn how and why film makes us feel. Our range also exposes students to cultures and traditions.



FAQs : Geography



We've put together a shortlist of frequently asked questions, we thought you might find useful. There is lots more information in the 'Student Life' section of our website, including what the curriculum covers for each subject in the 'curriculum maps' section. For further information please scan the QR code.

How many lessons a fortnight do KS3 students have for Geography ?

Four lessons over the two week timetable.

Do students participate in fieldwork at KS3?

We do local field work in the school grounds throughout the KS3 introduction to Geography unit, weather, water cycle, and environments. In both year 7 & 9 we complete fieldwork in Nailsea High Street. In year 8 we complete a day of studying 'rivers' in the Quantocks as our fieldwork.

What do you study in Key stage 3 Geography?

In Key Stage 3, Geographers study a range of exciting topics. We learn about places such as China, The Middle East, Russia and Kenya. We explore physical geographical processes through Rivers, Coasts, and Ice. We learn about how tectonics shape our planet and how we manage risk. We investigate human processes such as urbanisation, migration and development and how humans' impact on our biomes. We study weather and climate and explore the causes of climate change and how it can be managed. This means students are well placed to continue Geography if they choose to key stage 4.

Is Geography compulsory at KS4?

No, Geography is an optional subject.

Is Geography set?

No, our classes are mixed ability.



FAQs : History



We've put together a shortlist of frequently asked questions, we thought you might find useful. There is lots more information in the 'Student Life' section of our website, including what the curriculum covers for each subject in the 'curriculum maps' section. For further information please scan the QR code.

How many lessons of History do students have a fortnight?

Students have four lessons of History a fortnight.

What do you study in History at Key Stage 3?

In History at Key Stage 3 we aim to deliver a curriculum that is both knowledge and skills rich and that fosters the curiosity of our students. From Year 7 to 9 we follow a broadly chronological approach beginning with the Medieval Period in Year 7 through to the Modern Day in Year 9. We explore local, National and

International History such as the Bristol Boycott as part of looking at the experience of Black people in Britain through to World War One and Hitler's Rise to Power in Year 9.

What do you study in History in Year 7?

In Year 7 History we explore Medieval England beginning with the Norman invasion of 1066 and then look at the experiences of rulers in England and the experiences of ordinary people in England. We then move on to explore the Tudor period and look at the religious changes the English Reformation brings and how the Tudors interact with the wider world before finishing the year learning about the Stuarts and the transformative role of the English Civil War.

Are there any trips in History?

In Year 7 we visit Chepstow Castle to enrich our Norman Conquest topic. In Year 9 we run a residential trip to the World War One Battlefields in France and Belgium and visit a number of cemeteries, museums and take part in the Last Post Ceremony.

Is History compulsory at Key Stage 4?

History is an optional subject.



FAQs : Maths



We've put together a shortlist of frequently asked questions, we thought you might find useful. There is lots more information in the 'Student Life' section of our website, including what the curriculum covers for each subject in the 'curriculum maps' section. For further information please scan the QR code.

Do you set for Maths?

Currently Year 7 students are set into ability – sets are regularly reviewed.

How do you develop Maths learning?

We focus on developing student's mathematical thinking and reasoning skills by using a 'Mastery' approach to learning.

Is there any additional support?

We have an after school Maths Clubs - open to all students once a week to access some help or just to complete their homework!

What is homework like in Maths?

Homework is set once a week and feedback is given with next steps advice.

What can you do at home to help?

Use the topic overviews in your child's book (given at the beginning of each unit) to share their mathematical journey. Complete additional maths work outside of school e.g. MathsPad tasks. Promote workings out so that others can follow methods easily and understand what is going on. Encourage them to be confident in Maths.

What Maths enrichment is there on offer?

UKMT – both a team and individual competition, KS3 Aim Higher Booklet, Maths Factoids, Lunchtime inspirational lectures.



FAQs : Media Studies



We've put together a shortlist of frequently asked questions, we thought you might find useful. There is lots more information in the 'Student Life' section of our website, including what the curriculum covers for each subject in the 'curriculum maps' section. For further information please scan the QR code.

What is Media Studies?

It is the study of different types of media, such as newspapers, radio, video games and social media. We explore 4 key areas: language (how texts are constructed), representation (how people/places/events are shown to us, theories linked to this and how we respond), audience (why the media impacts us, what gratifications we get from the media) and industry (how texts are made, regulations with the media and industry issues). We also explore contexts of media, for example looking at gender roles in the 1950s and the advertising that used these in comparison to today. In addition, we have an element which is more creative and practical. Students are able to produce their own media, for example radio shows, TV and magazines.

Why should students study media?

In today's climate, media is one of (if not the) most important influences on society. We learn about the ways in which the media can manipulate us in order to become critical consumers. We take topics in the news, such as newspaper headlines, and explore their effect and impact on us.

Is it just about watching things and playing games?

Media is an academic subject - students explore theories and concepts linked to the media and apply them to our texts. In the exam, questions are evaluative, asking students to explore a statement with regards to the concepts surrounding it.

Where can media take me?

As Media is an analytical and creative subject, it has many links with other areas of the curriculum, such as History, English and Photography. Former students have gone to study media at university as well as film, graphic design and event planning. Some students now work in the media industry.



FAQs : Modern Foreign Languages (MFL)



We've put together a shortlist of frequently asked questions, we thought you might find useful. There is lots more information in the 'Student Life' section of our website, including what the curriculum covers for each subject in the 'curriculum maps' section. For further information please scan the QR code.

What languages do you offer?

French and Spanish; your child will be put in either a French or Spanish class at the start of the year.

(If you have a strong reason why they should study a particular language you should make this known before starting)

Do students get the opportunity to do a 2nd MFL?

Students focus on 1 MFL at KS3 but can opt for either at GCSE or both!

Do you offer trips abroad?

We have successfully run trips to Spain and France in the past few years.

Can students study both languages at GCSE?

Yes, students can choose to study one or both MFL at GCSE.

Similarly, if languages are not for them, they do NOT have to choose to study MFL beyond Y9 in our current curriculum model.

What if my child struggles with English?

All learners are fully supported and often learning a new language is a new opportunity for success and supports their literacy further.



FAQs : Music



We've put together a shortlist of frequently asked questions, we thought you might find useful. There is lots more information in the 'Student Life' section of our website, including what the curriculum covers for each subject in the 'curriculum maps' section. For further information please scan the QR code.

How many lessons of Music do students have a fortnight?

Students in year 7 8 and 9 have two lessons a fortnight. GCSE students have five lessons a fortnight.

What do you learn in Music lessons?

In KS3 students will learn a range of instruments including keyboard, ukulele, guitar, bass and drums, as well as group singing. They will work in pairs, small groups and whole class bands to play music in lots of different styles including pop, rock, reggae, the blues, classical and more. They will learn to write their own songs, and use music technology to compose electronic dance music and hip hop tracks. They will listen to a wide range of music and learn how it is created, inspiring their own playing and composing. Music lessons are practical and focussed on the key skills of listening, performing and composing. They are accessible to all, whether students have played music before or are starting an instrument for the first time.

What extra-curricular clubs are offered?

We have a wide range of clubs and activities including Choir, Big band, Music tech club, and String ensemble—see this years Extra Curricular brochure for more details.

Can we book instrumental or singing lessons?

Yes, you can book one-to-one lessons or small group sessions. The lessons we provide are: Guitar, Bass Guitar, Ukulele, Violin, Viola, Cello, Double Bass, Flute, Clarinet, Saxophone, Oboe, Drum Kit, Orchestral Percussion, Piano, Keyboard, Trumpet, Trombone, French Horn, Euphonium and Singing. Instruments can be hired from North Somerset Music Service and some can be hired from Nailsea School.



FAQs : Physical Education



We've put together a shortlist of frequently asked questions, we thought you might find useful. There is lots more information in the 'Student Life' section of our website, including what the curriculum covers for each subject in the 'curriculum maps' section. For further information please scan the QR code.

How many lessons of PE do students have?

4 lessons of PE every fortnight. Each lesson is 1 hour in duration.

Do you have to pay for extra curricular clubs?

All extra curricular PE sessions that are run by PE staff are free. Clubs run during lunchtime and after school. Please refer to the current offer on the website in the PE section.

Do you have fixtures against other schools?

Yes! We compete in a range of fixtures locally, regionally and nationally.

How are the classes grouped?

Students are assessed in Year 7 to create mixed groups that will create nurturing supportive environment.

Can students move from one group to another?

Yes, groups are regularly reviewed with changes made by staff at key points throughout the year to ensure students are within the best learning environment.

What sports / activities do the students learn?

The curriculum is as broad & varied as possible to help students engage with different aspects of PE. Programmes of study are available on the PE area of the website for specific teaching groups

How long do the groups spend on each block?

Approximately 5-8 lessons per activity. Each term (e.g. September to December) would have approximately 3 different activities

Do you offer PE qualifications and GCSEs?

Yes. We offer the GCSE PE and OCR Level 2 Cambridge National Sport Science at Key Stage 4, A level PE and OCR Cambridge Technical Sport and Physical activity at Key stage 5 as well as Sport Leaders level 1 for Year 9 and above.

What happens if a student has an illness or injury preventing them from joining in with PE?

We regularly have students in this situation and we provide adapted roles for them within the lesson e.g. mini teacher, coach, official, time keeper etc. Therefore, all students stay with their teacher and join in, but in a slightly different role. For all lessons students are expected to attend in PE kit unless injuries prevent this.



FAQs : Religious Studies



We've put together a shortlist of frequently asked questions, we thought you might find useful. There is lots more information in the 'Student Life' section of our website, including what the curriculum covers for each subject in the 'curriculum maps' section. For further information please scan the QR code.

What is studied in RS at Nailsea?

All students have RS lessons until Year 11. In Years 7 & 8 students are taught the main beliefs and practices of the key world religions giving them a deep and broad understanding of each faith. In Year 9, we study the lives and actions of key figures like Martin Luther King, Malala and Dietrich Bonhoeffer and ask how these individuals applied their faith in practical and brave ways.

What is studied in Year 7?

In Year 7, students begin with an introduction to religion asking questions such as, how it began, what are the similarities and differences within and between religions and how each one grew in prominence on both a global and regional scale. We then study the key stories from Old Testament developing the Biblical Literacy of students, laying foundations for future study. We then turn to one of the great and oldest Eastern religions, Hinduism. Students are introduced to key concepts such as karma, reincarnation and moksha as well as other practices like worship. We end Year 7 by an in-depth study of Judaism linking back to the stories in our study of the Old Testament.

Why is studying RS relevant to my child?

Religious Studies is a rigorous academic and challenging subject in the same way as History, Geography or English. Religious Studies equips students with the knowledge and understanding of the multi-faith world and country we live in. It prepares them for the diversity adult life will bring. Studying RS will help develop transferrable skills such as extended writing, empathy, oracy and debate that are required to succeed in all subjects in school.

Our family aren't religious. Why should my child study religious belief?

As mentioned in point 3, we live in a multi-faith nation. Faith plays a significant and important part in the lives of millions of British people and in the lives of billions of people around the world. Students and adults for that matter do not need to have a religious faith themselves in order to benefit greatly from the enriching experience of learning about the beliefs and lifestyles of religious people.



FAQs : Science



We've put together a shortlist of frequently asked questions, we thought you might find useful. There is lots more information in the 'Student Life' section of our website, including what the curriculum covers for each subject in the 'curriculum maps' section. For further information please scan the QR code.

How are students taught KS3 science at Nailsea?

In year 7 and 8, students are taught in mixed ability teaching groups by one science teacher. They will study a broad range of concepts from biology, chemistry and physics, whilst also acquiring key practical skills across all three areas. They will have 7 hours per fortnight. In year 9, students will be broadly banded into sets and study bridging topics between KS3 and KS4. They may have more than one teacher to prepare for specialist teaching at KS4, this is timetable dependent.

How are students taught KS4 science at Nailsea?

In year 9, students will decide via their options form if they wish to study triple science (separate Biology, Chemistry and Physics – 3 GCSEs). All three subjects are studied if this option is chosen with three subject specialist teachers. This covers 15 hours teaching per fortnight. Students who do not opt for triple science will be taught Combined science worth two GCSE grades. Both triple and combined science are taught by subject specialists and are available at higher and foundation tiers. For students following our alternative provision, we offer Entry Level Certification as an alternative to GCSE. All students are therefore able to access our science curriculum at a level suitable for them.

When will my son/daughter have more than one teacher?

At KS3 we prefer to go with continuity of staff member until Year 9 or Year 10, when teaching can be more specialist, but this is timetable dependent.

What A levels do you offer?

We offer the traditional Biology, Chemistry and Physics A level.

How much practical work do you do?

We try and teach through practical work as often as possible – our aim is to foster curiosity and learners with good transferable skills. We are very fortunate to be supported by amazing, knowledgeable science technicians and we have beautiful facilities!

